



ResMed Case Study:

# Optimizing Space for a Hybrid Workforce

[VIEW GALLERY](#)



To visit our  
**HRM Showroom**  
call (902)-468-3200  
or go to  
[atlanticbusinessinteriors.ca](http://atlanticbusinessinteriors.ca)

# About ResMed

**ResMed specializes in cloud-connected medical equipment, including CPAP devices and masks for sleep apnea, ventilators for respiratory diseases, and software for out-of-hospital care agencies. They aim to improve transitions of care for seniors and their caregivers.**

While ResMed is headquartered in San Diego, California, their presence is global, having had an office located in Halifax for several years. ResMed teamed up with Atlantic Business Interiors and SGH Design Partners to facilitate the transition to their new office in Bedford, Nova Scotia.

This transition involved a conceptual shift in workplace strategy to accommodate their mobile and hybrid employees.



# Their Challenge

**ResMed's objectives involved optimizing space utilization in their new office environment, transitioning to an unassigned workspace model.**

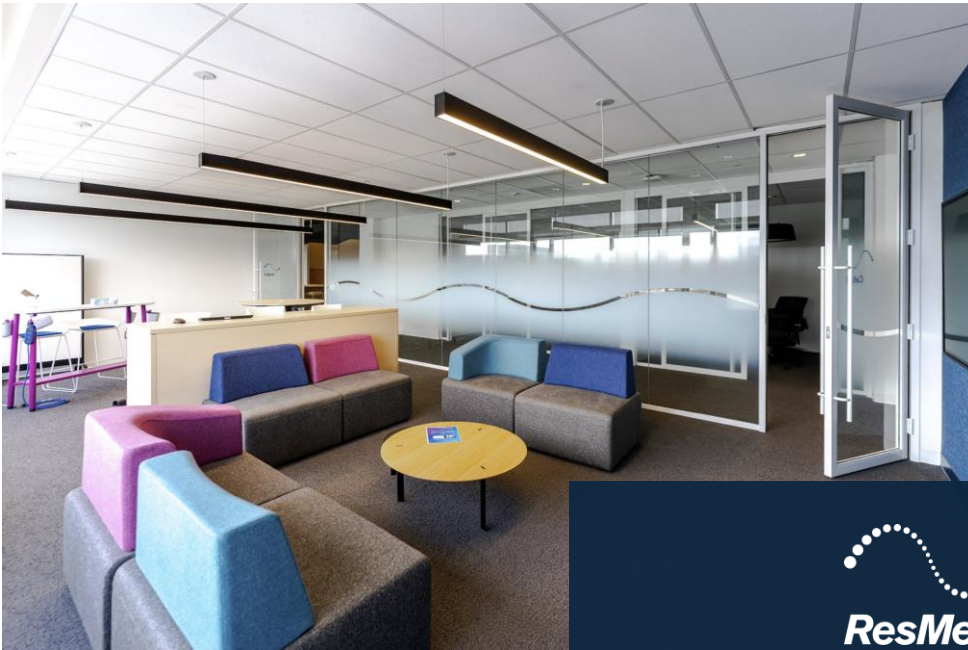

Relocating ResMed's Halifax office to Bedford, Nova Scotia, demanded a comprehensive redesign of their workspace, encompassing nearly 28,000 USF spread across a full floor.

The workstation furniture needed to support a 'plug and play' approach, offering flexibility and privacy for employees. Additionally, offices were to function as hotelling spaces while doubling as meeting rooms when not in use.

Meeting room tables were expected to accommodate advanced AV solutions and efficient cable management.



**Industry:** Medical Products



**Workspace:** Hybrid



**Office Size:** 27,867 USF



**Year founded:** 1989



**Key Considerations:**

- Private, flexible & functional workspaces
- Multi-function offices
- Meeting rooms outfitted with AV solutions & cable management

# Our Solution

**Atlantic Business Interiors collaborated with SGH Design Partners with an emphasis on creativity and functionality across a variety of workstations, meeting areas, and storage solutions.**



The demand for adaptable and ergonomic workstation furniture cannot be overstated. A 'plug and play' approach enhances efficiency while fostering a dynamic and collaborative work environment. ResMed's employees are enabled to move seamlessly between workspaces according to their tasks, boosting concentration and workflow.

Investing in 'plug and play' workstations and workspaces has become essential for optimizing employee satisfaction, performance, and overall workplace functionality.

Up-to-date AV solutions were crucial in enhancing communication and collaboration in a productive workplace, facilitating seamless interactions and presentations.

Efficient cable management ensured a tidy workplace, reducing clutter, and minimizing the risk of technical issues.

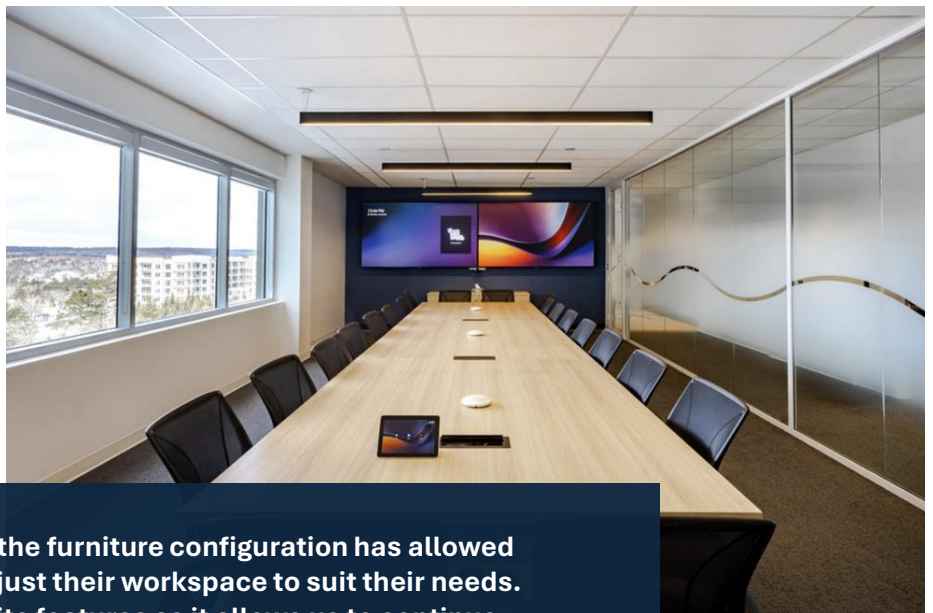

**“The modular design of the furniture configuration has allowed teams to seamlessly adjust their workspace to suit their needs. This is one of our favourite features as it allows us to continue to create an inclusive environment while meeting the ever-changing needs of our team members.”**

Krista Beni, ResMed Project Manager

# Outcomes

**The project's detailed specifications and collaborative approach between ResMed, SGH Design Partners, and Atlantic Business Interiors set the stage for a successful office relocation and redesign.**

By focusing on innovative solutions, functionality, and ongoing client input, the team ensured that the furniture selections and design elements harmonized with ResMed's objectives for their new workspace in Bedford, NS.

